

B

UILDING FROM THE HEART

Construction of a New Heart Hospital

The University of Tennessee Medical Center has experienced tremendous growth during the past couple of years, and the need to keep pace with this rapid growth has required us to expand our physical space. The Tennessee Health Services Development Agency has approved a “certificate of need” that will enable the Medical Center to build an additional patient tower. That new structure will be located on the Medical Center’s front flag circle and

will be called the Heart Hospital, the first of its kind in the region.

Why do we need a dedicated Heart Hospital? The National Center for Health Statistics estimates that one in three American adults have one or more types of cardiovascular disease, accounting for one out of every four hospital admissions. And over the next two decades the number of admissions for heart, lung, and vascular disease

is expected to increase substantially. How does Tennessee place? Heart disease is the leading cause of death for Tennesseans and the state ranks third highest in the nation for heart disease-related deaths. That is why the University of Tennessee Medical Center takes seriously the responsibility to expand capacity to continue to meet the needs of the region and to provide the most advanced care available.



The ground breaking ceremony for the Heart Hospital brought together many excited staff and visitors. Pictured above are Teresa Levey; Dale Wortham, MD; Michael Freeman, MD; Bernard Bernstein; Joe Landsman; John Mack, MD; Paul Branca, MD; and Reverend Ben Lewis.

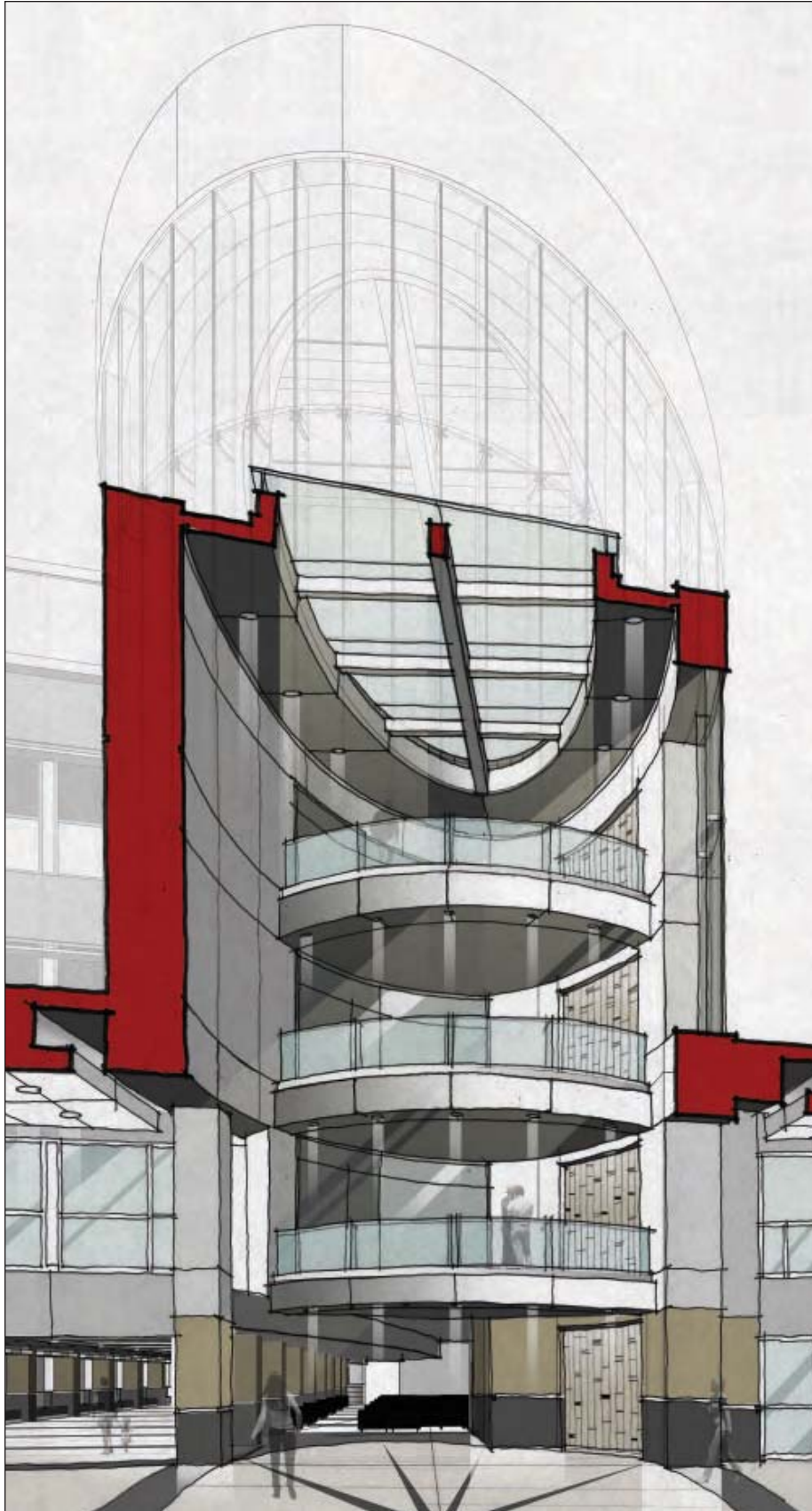

In the Heart Hospital's first phase, the four-story building will include a beautiful atrium area that will serve as the front lobby and main entrance. People entering the lobby will look up at four stories of airy, glass-walled space under a spectacular rotunda, with open balconies marking the three floors above.

To the right they'll find a donor-recognition area; to the left will be access to endoscopy and MRI registration. This first level of the new tower will create a much larger and more efficient state-of-the-art endoscopy department and will also make it possible to renovate the existing space.

Straight ahead will be a hallway or concourse. Patients and visitors will walk a short distance to a new information desk at the intersection



of hallways leading directly to the Emergency Department and to physician office buildings A, B, and C. Displayed along the concourse will be photographs documenting the history and milestones of the Medical Center and images expressing who we are now. A new conference and meeting area as well as space for a patient information center so patients and their families can research health information are also planned.

The second floor of the Heart Hospital will house a new 24-bed private-room cardiovascular intensive care unit (an increase over the 18 beds we currently

The Preston Medical Library

Preston Medical Library has served the information needs of the University of Tennessee Medical Center and the East Tennessee region for more than 40 years.

As a department of the UT Graduate School of Medicine, the library supports residency programs and other educational programs of the school—but it serves patient families and the broader community too. In fact, almost a quarter of the information services provided by Preston Medical Library go to community members: patients, patient families, area physicians, and attorneys.

Growing the Preston Medical Library will allow us to expand our services offered to patient families. The new library, to be located next to the Heart Hospital's lobby, will contain all the resources needed by anyone seeking health or medical information. Patients and their families will have more resources at their fingertips to research and learn more about diseases, conditions, and treatments.

Arriving at Preston Medical Library's new consumer library, patients and visitors will find a bright, modern area where a reference librarian will greet them and guide them to the information they need. They'll also be able to connect laptop computers to the building's wireless network in a setting designed for comfort. This dedicated space, offering a large book collection, brochures and pamphlets on specific diseases and conditions, and computers (including some with adaptive technology for the hearing- and sight-impaired), will put valuable health information within easy reach. Most important, professional staff will be available to help locate the desired information and dissect mystifying medical terminology.

have), plus a family area where families are able to be an integral part of the healing process. When visitors step off the elevator, they'll find a new surgery waiting area for families to their left and a new cardiovascular intensive care family lounge almost straight ahead. Centralized core nursing staff along with nursing alcoves located outside each patient room will allow for individualized nursing care.

The cardiovascular intensive care rooms will offer patients' families space to visit and participate in the care of their loved ones. Each room will have bath and restroom facilities and a sofa. The sofa will convert to a one-person bed for overnight stays by a family member. Studies show that private patient rooms are associated with lower incidences of infection, less noise, increased patient privacy, greater patient satisfaction, and faster recovery.

This first phase of the tower, which is expected to be complete early in 2010, will also include two floors of shelled space that can accommodate 32 patient beds per floor. Construction on the project began last month. We're certain that this addition to the Medical Center campus will greatly enhance our ability to serve the people of our region.

The second phase of expansion will provide the Heart Hospital with four more floors and will be completed at a later date. This change to the Medical Center campus will transform the future of healthcare in the region by providing multidisciplinary cardiac care in an atmosphere designed for compassionate patient and family interaction.

Heather Grieve



Sandy Oelschlegel